

SYSTEM PROFILES
NOT TO SCALE

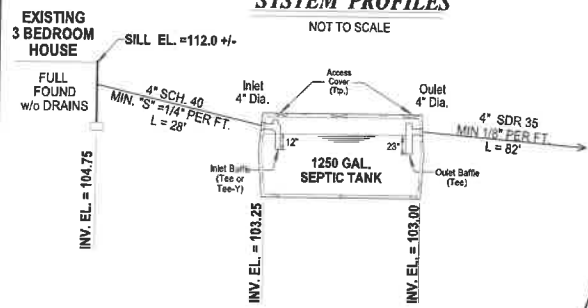

- BOTTOM OF LEACH FIELD = BOTTOM OF ADVANCED ENVIRO-SEPTIC PIPES
- SWING TIES ARE TO OUTSIDE CORNERS OF ADVANCED ENVIRO-SEPTIC PIPES
- REMOVE STUMPS & BOULDERS WITHIN 10' OF LEACH FIELD
- USE CARE TO DISTURB RECEIVING AREA AS LITTLE AS POSSIBLE WITH MACHINERY
- ALL MATERIALS AND CONSTRUCTION METHODS TO COMPLY WITH "ADVANCED ENVIRO-SEPTIC LEACHING SYSTEM DESIGN & INSTALLATION HANDBOOK FOR THE STATE OF N.H." PREPARED BY PRESBY ENVIRONMENTAL, INC., SUGAR HILL NH
- "ADVANCED" ENVIRO-SEPTIC PIPES TO BE USED
- INSTALL LOW VENT

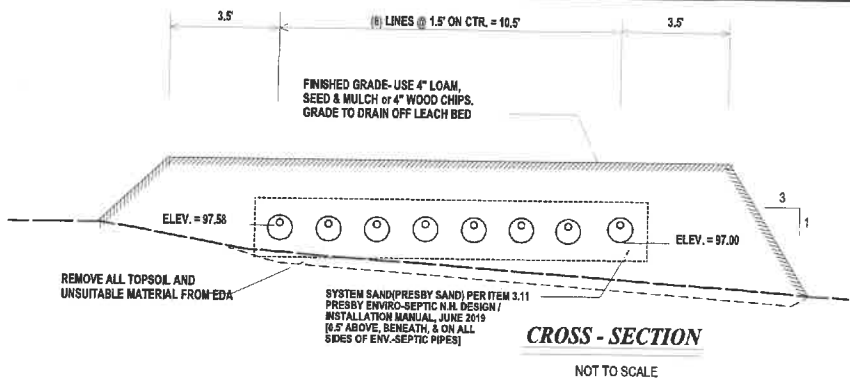

GENERAL NOTES

- DESIGNER MUST BE NOTIFIED OF ANY SITE CONDITIONS DIFFERENT FROM THOSE SHOWN ON THIS PLAN.
- ELEVATION DATUM IS ASSUMED. ALL GRADES AND INVERT ELEVATIONS TO BE REFERENCED TO BENCHMARK(S) SHOWN ON THE PLAN.
- UNLESS SPECIFICALLY NOTED ON THE SYSTEM PROFILE, CONCRETE PRODUCTS MAY BE SUPPLIED BY A.J. FOSS, DEL GILBERT, OR EQUAL.
- ALL CONNECTIONS BETWEEN A SEPTIC TANK AND THE PIPES LEADING TO AND EXITING FROM THE SEPTIC TANK SHALL BE SEALED WITH A WATERTIGHT, FLEXIBLE JOINT CONNECTOR THAT WILL ACCOMMODATE NORMAL MOVEMENT OF THE SEPTIC TANK WITHOUT BREAKING OR LEAKING. SEPTIC TANK(S) TO BE ADEQUATELY SEALED TO PREVENT INFILTRATION/EXFILTRATION.
- THE SLOPE OF THE INTERIOR LENGTH OF ANY PIPE THAT EXTENDS INTO A SEPTIC TANK SHALL NOT EXCEED THE MINIMUM PITCH AS SPECIFIED IN Env-Wq 1009.05(a).
- INSTALL FLOW EQUALIZERS IN D-BOX WHEN 2 OR MORE OUTLET LINES ARE USED.
- THIS SYSTEM IS NOT DESIGNED TO ACCOMMODATE A GARBAGE DISPOSAL.
- DO NOT DISCHARGE WATER SOFTENER OR TREATMENT BACKWASH INTO THE SEPTIC SYSTEM
- ALL CONSTRUCTION METHODS & COMPONENTS TO COMPLY WITH NHDES WS1000 SPECS AND ALL REQUIREMENTS OF THE MANUFACTURER.
- IN THE EVENT OF LEACH BED FAILURE, CONTACT DESIGNER AND INSTALLER FOR ASSISTANCE IN DETERMINING THE REASON FOR THE FAILURE. IF NECESSARY, REBUILD IN PLACE-IN KIND, OR SUBMIT REVISED PLANS.
- THIS PLAN IS FOR THE CONSTRUCTION OF THE SEWAGE DISPOSAL SYSTEM ONLY. ANYONE USING INFORMATION FROM THIS PLAN FOR ANY OTHER REASON DOES SO AT THEIR OWN RISK.
- THE DRIVEWAY PERMIT IS NOT A PART OF THIS APPLICATION, AND WHEN REQUIRED SHALL BE OBTAINED BY OWNER.

LAYOUT INFORMATION		
DISTANCE FROM:	REF. STK. #1	REF. STK. #2
A	55.0'	44.9'
B	94.5'	78.2'
C	94.0'	83.7'
D	54.0'	53.7'
TANK OUT	47.3'	58.1'
TANK IN	55.1'	61.8'
DISTANCE FROM:	REF. PT. #3	REF. PT. #4
TANK OUT	37.6'	45.9'
TANK IN	30.0'	41.4'
DIAGONALS: A to C = 42.1' B to D = 42.1'		

DESIGN DATA: 3 BEDROOMS = 450 GAL./DAY
+ 1 APARTMENT = 225 GAL./DAY
TOTAL LOADING = 675 GAL./DAY

FROM MANUFACTURERS TABLE:
675 G.P.D. @ 2 MIN/INCH = 315 L.F. "ADVANCED" ENVIRO-SEPTIC PIPE REQ'D.
(9) LINES @ 40' = 360 L.F. PROVIDED.

DESIGN INTENT: BOTTOM OF LEACH BED (ELEV. 97x00) TO BE NO MORE THAN 8" BELOW EXISTING GRADE @ HIGH CONTOUR. HIGHEST OLD GROUND ELEVATION IN LEACH FIELD = 97x75.

LOT LOADING DATA: (MEF - MARLOW, GROUP 3, 8 - 15 % SLOPE)

600 GPD / 2000 GPD PER ACRE x 1.76 FACTOR = 25,875 S.F. REQUIRED

52,340 SQ. FT. (OUTSIDE OF POORLY DRAINED SOILS)
LESS 17,662 S.F. (WELL RADIUS) = 34,678 S.F. PROVIDED

TOWN OF JACKSON LOT LOADING REQUIREMENTS:
FROM TABLE II: CATEGORY 2, 8-15% SLOPES = 46,000 SQ. FT. REQ'D.
(FOR A 4 BEDROOM DWELLING)

3 BEDROOM REQUIREMENT = 0.63 x 46,000 SQ. FT. = 28,980 SQ. FT.
1 BEDROOM ADU = 0.30 x 46,000 SQ. FT. = 13,800 SQ. FT.
0.40 x 60,500 = 24,200
TOTAL REQ'D. = 61,980 SQ. FT. (52,340 SQ. FT. PROVIDED)
86,515 Town Review Notes

MEF: MARLOW - very stony fine sandy loam association, very steep
REF.- MAP 8, SOIL SURVEY OF CARROLL COUNTY 1977

TOWN OF JACKSON ZONING ORDINANCE

APPROVED
APPROVED AS NOTED
X NOT APPROVED, RESUBMIT

Approval is for compliance with the Town of Jackson Zoning Ordinance and does not imply or guarantee approval by the New Hampshire Department of Environmental Services.

REC'D 2/11/22 CKD BHD.P.CS RETURN 2/14/22

Notes: Application not approved because the lot does not appear to comply with Section 6 (Lot Sizing) of the ZO.

NOTE:
CONSTRUCTION OF THIS SEWAGE DISPOSAL SYSTEM MUST COMPLY WITH SECTION 4.1.6 - SITE DISTURBANCE - OF THE JACKSON ZONING ORDINANCE

TEST PIT #1 DATA	DATE: 08/28/2018
0" - 8" ORGANIC & TOPSOIL	
8" - 18" 10YR 4/3 BROWN LOOSE MEDIUM STONY SANDY LOAM, GRANULAR, SUB-ANGULAR, POORLY SORTED, ROOTS COMMON	
18" - 27" 2.5Y 5/4 OLIVE BROWN COARSE VERY STONY LOAMY SAND, GRANULAR, SUB-ANGULAR, POORLY SORTED	
27" - 66" 2.5Y 5/3 LIGHT OLIVE BROWN VERY COARSE VERY STONY LOAMY SAND, GRANULAR, ANGULAR, POORLY SORTED, VERY FIRM IN PLACE, DISTINCT MOTTLES	
NO LEDGE NO WATER ESHWT @ 27"	
PERC RATE = 8 MIN. / INCH @ 21"	

TEST PIT #2 DATA	DATE: 12/01/2021
0" - 6" ORGANIC & TOPSOIL	
6" - 24" 10YR 4/3 BROWN LOOSE MEDIUM VERY STONY SANDY LOAM, GRANULAR, SUB-ANGULAR, POORLY SORTED, ROOTS COMMON	
24" - 38" 10YR 4/4 DARK YELLOWISH BROWN VERY STONY VERY COARSE SAND, SINGLE GRAIN, POORLY SORTED, 60% SUB-ANGULAR COBBLES TO 12" DIAMETER, SOME ROOTS	
27" - 66" 10YR 4/4 DARK YELLOWISH BROWN VERY STONY VERY COARSE SAND, SINGLE GRAIN, SUB-ANGULAR, POORLY SORTED, DISTINCT MOTTLES	
NO LEDGE WATER @ 42" ESHWT @ 38"	
PERC RATE = 2 MIN. / INCH @ 30"	

PROPERTY DATA

- TOWN TAX MAP R12 / LOT 146
- SUBDIVISION NAME: N/A
- CARROLL CO. REGISTRY BK. 1630 / PG. 201
- CARROLL CO. REG. PLAN BK. / PG. - N/A
- NHDES SUBD. APPVL. # - N/A (PRE-1967)
- [SEE DEED BK. 351 / PG. 48, 03/28/1961]
- PRIOR NHDES CONST. APPVL. # - NONE FOUND

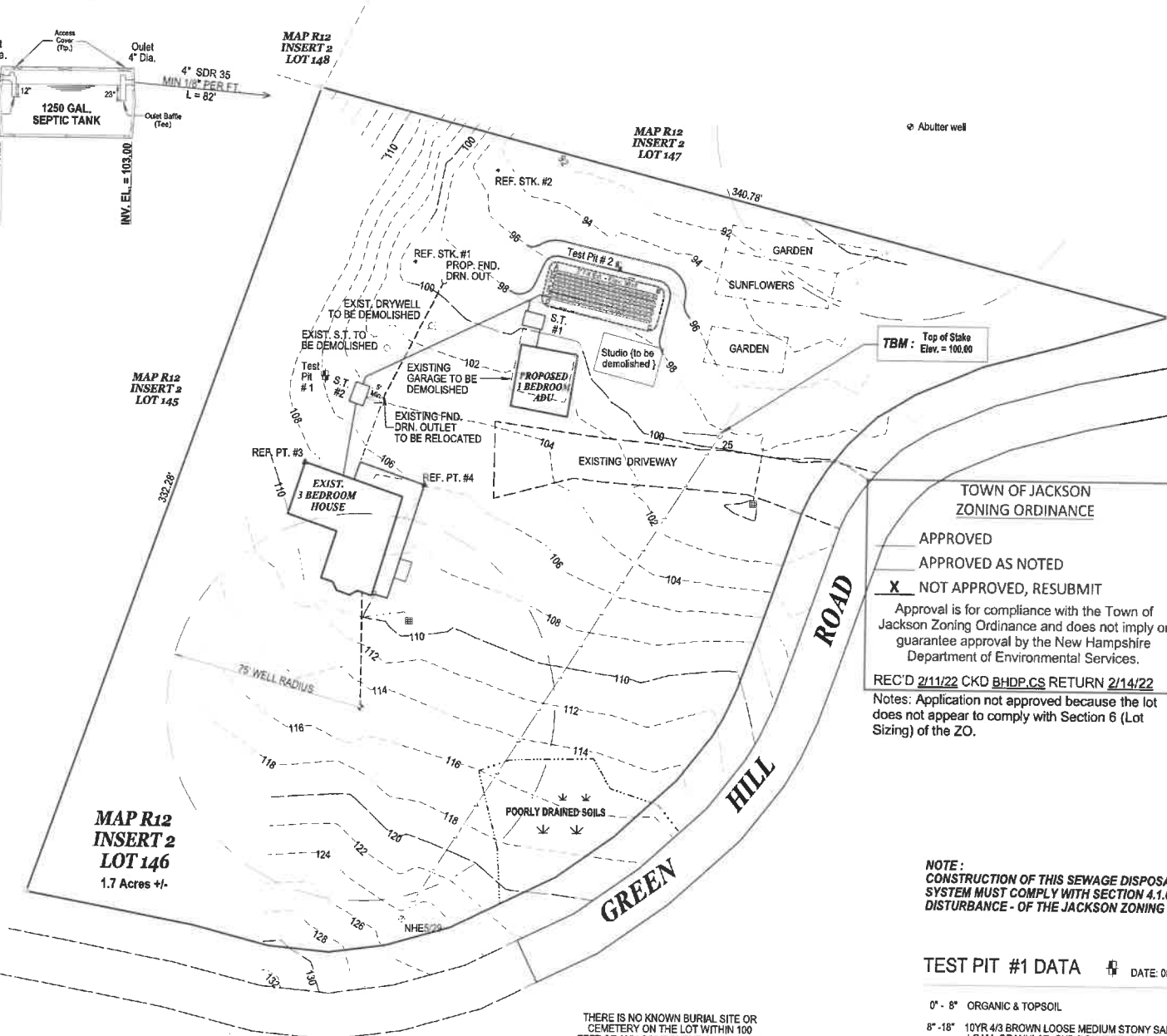

THIS PLAN DOES NOT REPRESENT A BOUNDARY SURVEY, AND CANNOT BE USED AS SUCH

NO SURFACE WATERS, WETLANDS OR WELLS WITHIN 75' OF ANY PART OF THE PROPOSED SEWAGE DISPOSAL SYSTEM.

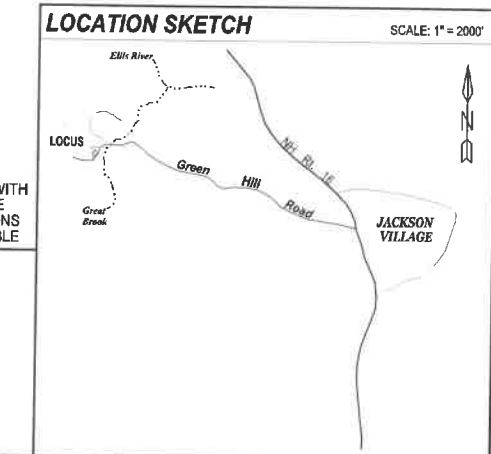

THIS PLAN COMPLIES WITH ALL LOCAL SEWAGE DISPOSAL REGULATIONS WHICH ARE APPLICABLE

SEWAGE DISPOSAL SYSTEM PLAN AND DETAILS
LOCATED IN JACKSON, NH

PREPARED FOR:		MARK J. & SUSAN J. ROSS-PARENT	
MAP R12 / LOT 146 GREEN HILL ROAD			
PREPARED BY: BRIGGS LAND SURVEYING		P.O. BOX 1587	
Tel. (603) 447-6647		CONWAY, NH 03818	
SCALE: AS NOTED	NHDES CONSTRUCTION APPROVAL #	FILE NO. - 181106	
DATE: 12 / 20 / 2021		DWG. NO. - SS1	